

LoFric[®]
Cath-Kit™

A convenient hydrophilic catheter system for CIC





Cath-Kit is about making everyday life a little easier for users.

Portable convenience

Having freedom of movement in everyday life is often very important for the quality of life. When one is dependant on self-catheterization, finding a toilet may not always be easy. LoFric Cath-Kit is the LoFric catheter combined with a urine collection bag. Everything needed to self-catheterize without access to a toilet - just add water and it's ready to be used.

Proven clinical benefits

The catheter's surface layer binds water and is virtually frictionless upon insertion and removal. Compared with other catheters, the friction against the urethra is reduced up to 95%, offering reduced risk of UTIs and complications, and greater comfort. Because the kit is completely closed, the catheter maintains its unique chemical properties and the surface layer stays intact until it is ready to be used.

Catheter sizes

6FR	
8FR	
10FR	
12FR	
14FR	
16FR	
18FR	

LOFRIC® CATH-KIT PRODUCT RANGE

PRODUCT #	TYPE	SIZE
910840	LoFric Cath-Kit, Male	16" 8FR
911040	LoFric Cath-Kit, Male	16" 10FR
911240	LoFric Cath-Kit, Male	16" 12FR
911440	LoFric Cath-Kit, Male	16" 14FR
911640	LoFric Cath-Kit, Male	16" 16FR
911840	LoFric Cath-Kit, Male	16" 18FR
971040	LoFric Cath-Kit, coudé	16" 10FR
971240	LoFric Cath-Kit, coudé	16" 12FR
971440	LoFric Cath-Kit, coudé	16" 14FR
971640	LoFric Cath-Kit, coudé	16" 16FR
971840	LoFric Cath-Kit, coudé	16" 18FR
950840	LoFric Cath-Kit, Female	8" 8FR
951040	LoFric Cath-Kit, Female	8" 10FR
951240	LoFric Cath-Kit, Female	8" 12FR
951440	LoFric Cath-Kit, Female	8" 14FR
951640	LoFric Cath-Kit, Female	8" 16FR
951840	LoFric Cath-Kit, Female	8" 18FR
930640	LoFric Cath-Kit, Pediatric	8" 6FR
930840	LoFric Cath-Kit, Pediatric	8" 8FR
931040	LoFric Cath-Kit, Pediatric	8" 10FR

CONVENIENT AND PORTABLE PRODUCT

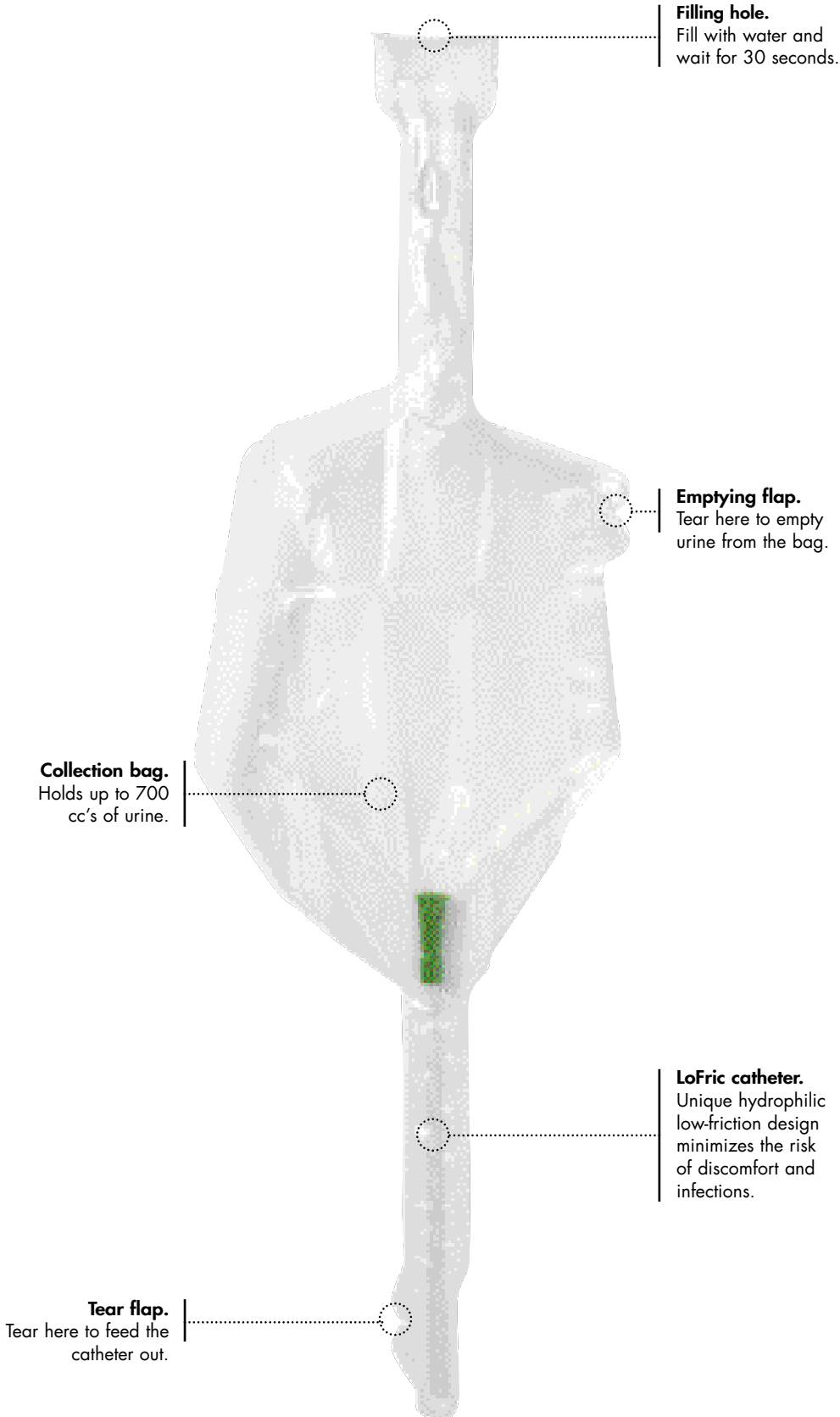

Directions for Use:

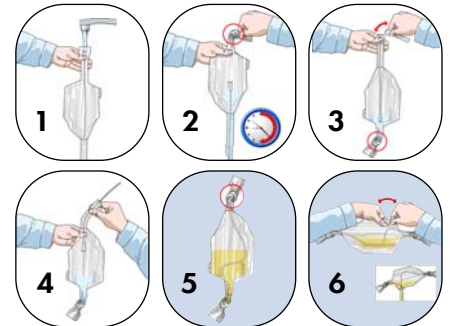

1. Hold the product upright as shown and add water to the 700 mark.
2. Push the catheter down into the tail of the bag and tie off the neck. Soak the catheter for at least 30 seconds.
3. Invert the bag and tear off at the flap where shown
4. Ease the catheter up through the tail of the bag as shown and catheterize.
5. After catheterizing, push the catheter back into the bag and tie off the tail.
6. The bag has a tear flap for emptying the contents prior to disposal, if necessary.

LoFric is designed for one-time use only.

After a single use, the hydrophilic coating is not assured to hold its lubricating water layer on inside the urethra. This may cause injury to the urethra and /or increase the risk of infection.

All components are 100% latex-free.

Knowledge, education and support

If you need additional information, we have comprehensive knowledge in all the areas associated with catheterization, dilatation, and instillation. We are willing to act as a resource, or to provide education for you and your staff.

When it comes to education and information, we have a broad program - both for healthcare professionals and for users. You may use our training staff, or the training and information on video and in print. Apart from that, we have information on products, clinical studies, user guides, starter kits, and much more. Contact us for all your needs.

77785-US-0504

